



MY WAY V MONDOMARINE 131



MY WAY V

BUILDER : Mondomarine

MODEL: 131

YEAR: 2005 **REFIT:** 2024

ENGINES : 2 x MTU 12V 396 TE 94 -2 255 hp

LENGTH: 40 M

CABINS: 5

FLAG: Malta

A floating work of art designed to provide an unparalleled sailing experience.

At 40 metres in length, this iconic vessel perfectly combines timeless elegance, cutting-edge performance and absolute comfort for an unforgettable holiday at sea.

My Way V's elegant, timeless design is immediately striking. Designed by some of the world's leading naval architects, the vessel boasts clean lines, high quality finishes and refined details. Whether on the water or in the harbour, this striking yacht embodies the ultimate in style and prestige.

The sumptuous interiors are designed to provide the ultimate in comfort, with spacious living areas, fine materials and meticulous attention to detail. Elegant staterooms offer sanctuaries of tranquillity, while luxurious lounges are perfect for relaxing and entertaining.

PRICE: 6 900 000 € Vat paid









MAIN DECK



MAIN DECK



MAIN SALON



MAIN SALON



MAIN SALON



MAIN SALON



UPPER DECK



UPPER DECK



UPPER DECK



UPPER DECK



UPPER DECK SALON



UPPER DECK SALON



FOREDECK



FOREDECK



FOREDECK



FOREDECK



COCKPIT



FLYBRIDGE



FLYBRIDGE



FLYBRIDGE



FLYBRIDGE



LOWER DECK



OWNER CABIN



OWNER CABIN



OWNER BATHROOM



VIP CABIN



VIP BATHROOM



GUEST CABIN



GUEST CABIN BATHROOM



GUEST CABIN 1



GUEST CABIN 1 BATHROOM



TWIN CABIN











SPECIFICATIONS

BUILDER : Mondomarine

CRUISE SPEED : 12 KT

MODEL : 131

MAX SPEED : 20 KT

YEAR: 2005 **REFIT:** 2024

GUESTS CABINS : 5

HULL / SUPERSTRURE MATERIAL : Aluminium

MAX GUESTS CAPACITY : 12

LENGTH : 40 M

MAX GUESTS SLEEPING : 10

BEAM : 8.40 M

CONSUMPTION : 210 L/H @ 12 Knots

DRAFT : 2.30 M

AUTONOMY : 1500 NM

NAVIGATION CLASS : A

FUEL TANK CAPACITY : 42 000 L

CLASSIFICATION: Malta commercial

WATER TANK : 7 290 L

FLAG: Malta

BLACK WATER TANK : 500 L

GROSS TONNAGE : 339 GT

BOW AND STERN THRUSTER: Yes

LAYOUT

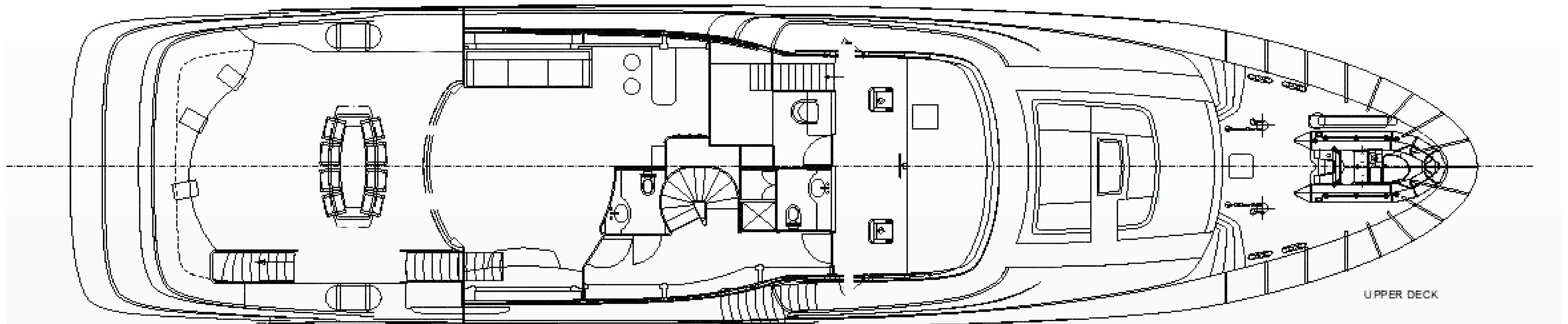
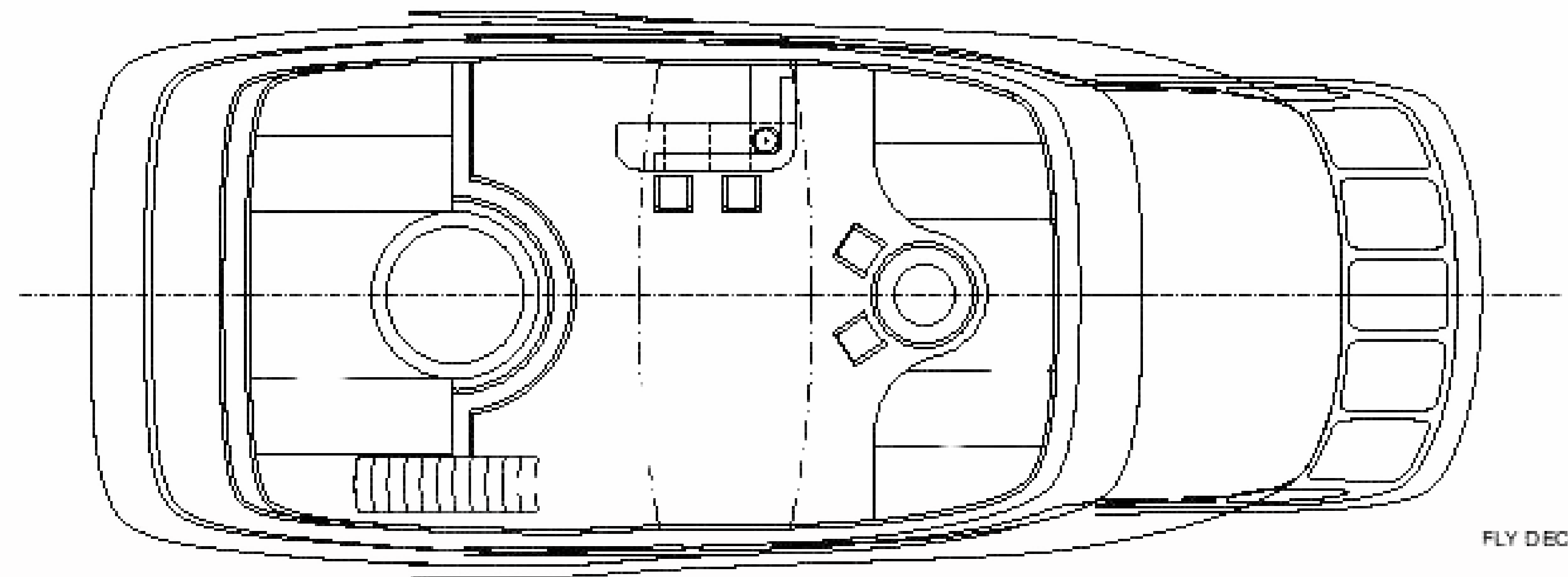

LAYOUT

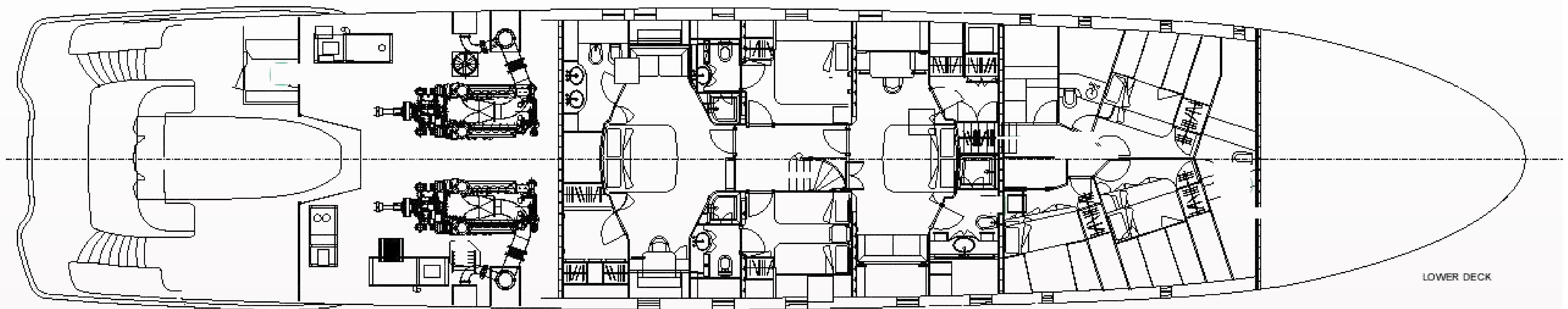
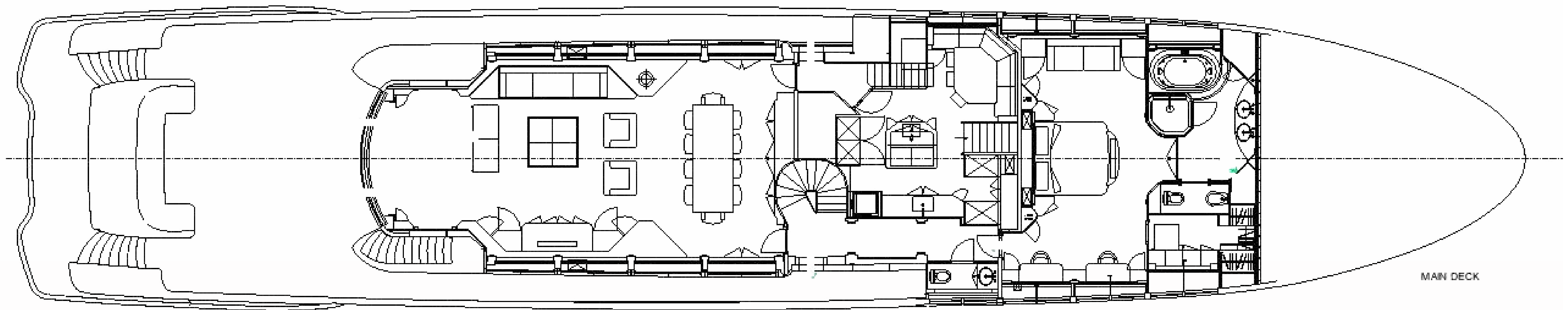



Aquila yachting
29 Port Camille Rayon 06220 Golfe Juan FRANCE
www.aquilayachting.com

Contact: +33(0)6 10 27 79 66
Mail: sales@aquilayachting.com

